

3.50mm (.138") High Withstanding Voltage Power Connectors

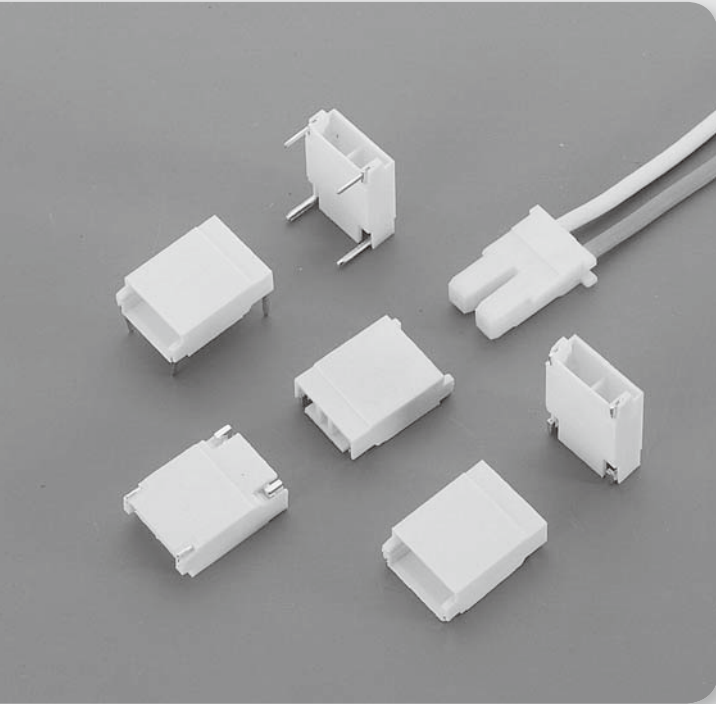

Specifications

- Voltage Rating : 1,400V AC/DC
- Current Rating : 1A AC/DC
- Withstanding Voltage : 3,800V AC/minute
- Insulation Resistance : 1,000M min.
- Temperature Range : -25°C to + 85°C
- Contact Resistance : 20mΩ max.

Features:

■ HOUSING

Part No. : JS-2011 (Receptacle)

JS-2021 (Plug)

Poles : 2

Material : Nylon 66 UL94V-0

Q,ty : 1,000 pcs/Bag

■ WAFER

Part No. : JS-2012 (SMT Type)

JS-20121 (DIP Type)

JS-2013-02 (SMT Type; With Lock)

JS-20131-02 (DIP Type; With Lock)

JS-2013D-04 (SMT Type; With Lock, 2 in 1)

JS-20131D-04 (DIP Type; With Lock, 2 in 1)

Poles : 2, 4

Material : Contact : Phos. Bronze, Tin Plated

Base : PA 9T UL94V-0

Q,ty : 1,200 pcs./Tape & Reel (JS-2012, JS-2013)

1,000 pcs./Tube Pack (JS-20121, JS-20131)

■ TERMINAL

Part No. : JS-2011-T (Female)

JS-2021-T (male)

Applicable Wires : AWG# 24 - 28

Material : Phos. Bronze

Finish : Tin Plated

Thickness : 0.2mm

Q,ty : 10,000 pcs/Reel

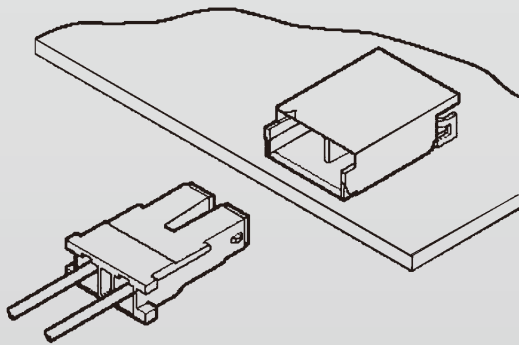

3.50mm (.138") High Withstanding Voltage Power Connectors

Housing - Receptacle JS-2011-02

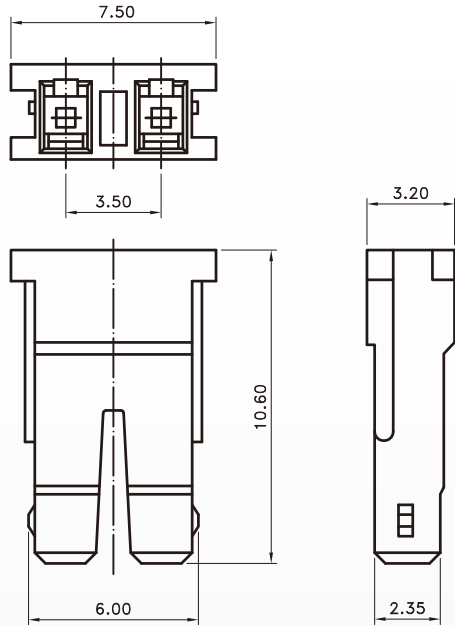

Housing - Receptacle plug JS-2021-02

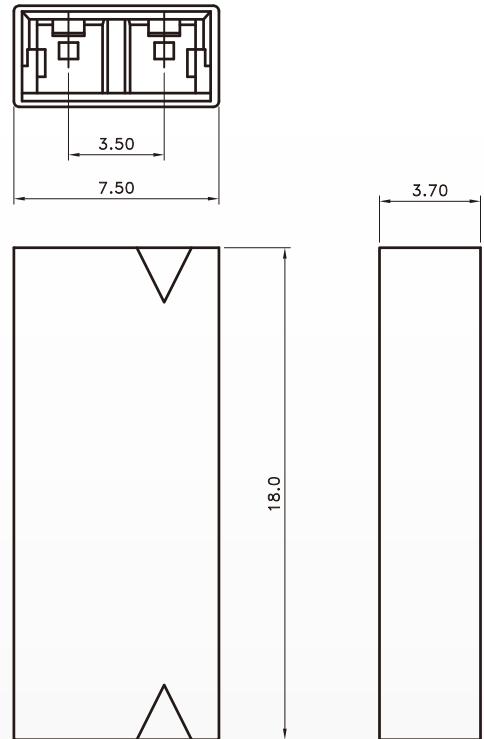

Terminal JS-2011-T

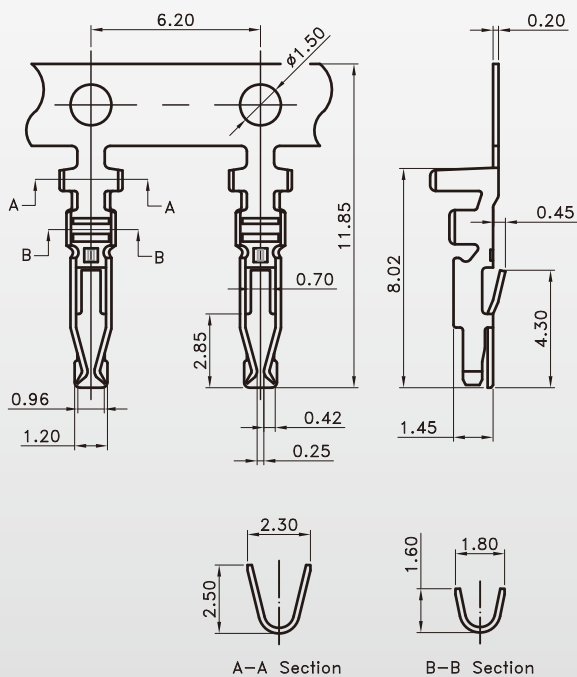

Terminal JS-2021-T

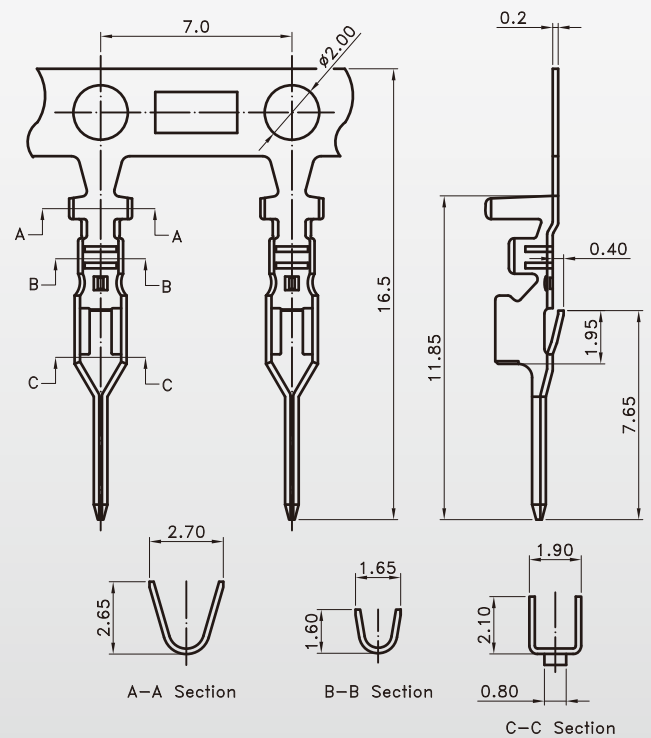

C

3.50mm (.138") High Withstanding Voltage Power Connectors

Wafer < SMT Type > JS-2013-02 (With Lock)

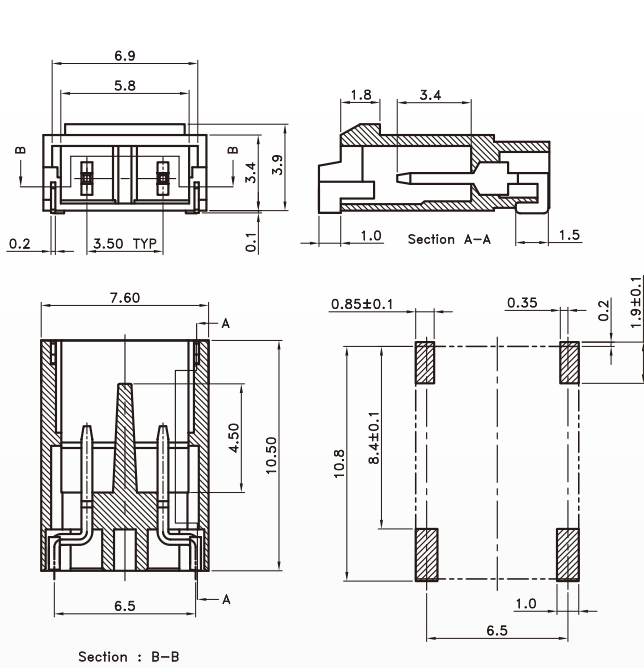

Wafer < DIP Type > JS-20131-02 (With Lock)

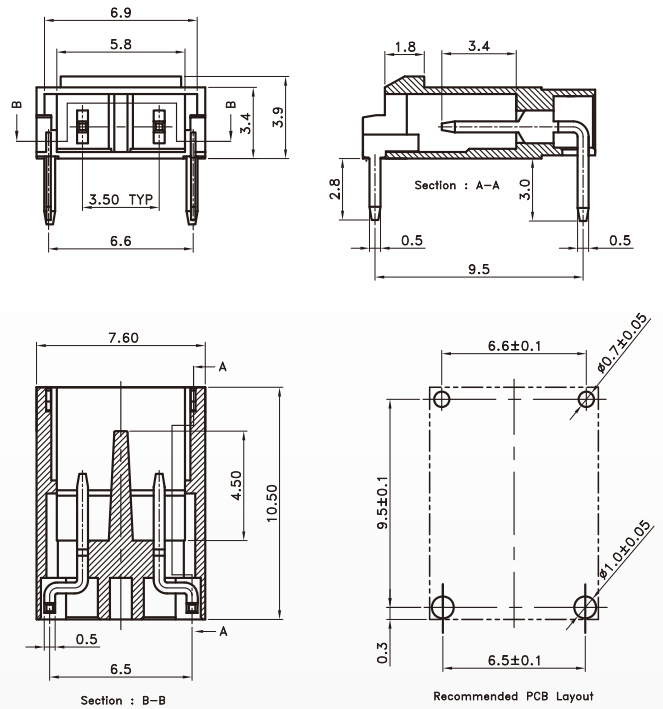

Wafer < SMT Type > JS-2012-02

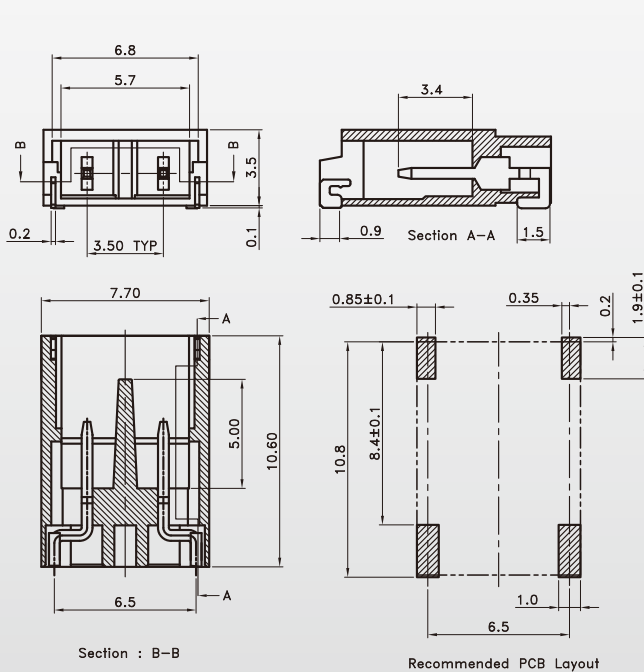

Wafer < DIP Type > JS-20121-02

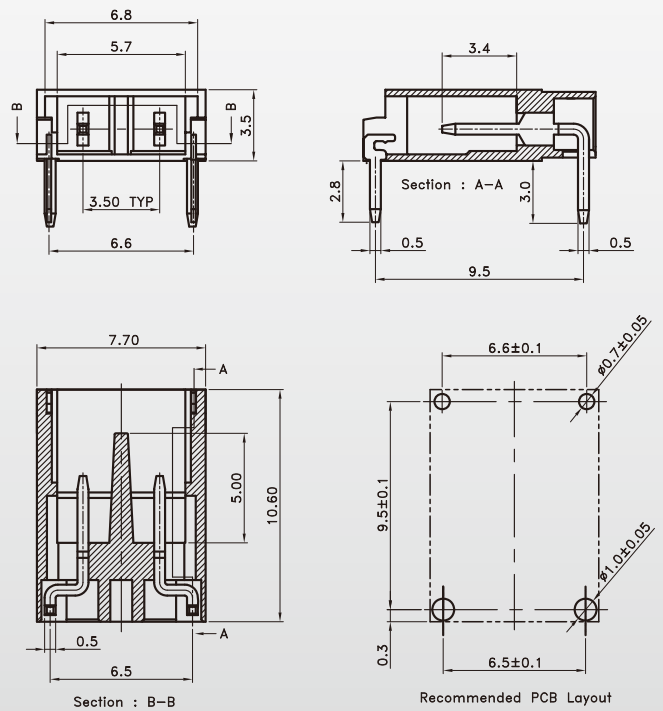

3.50mm (.138") High Withstanding Voltage Power Connectors

Wafer < SMT Type, With Lock > JS-2013D-04 (2 in 1)

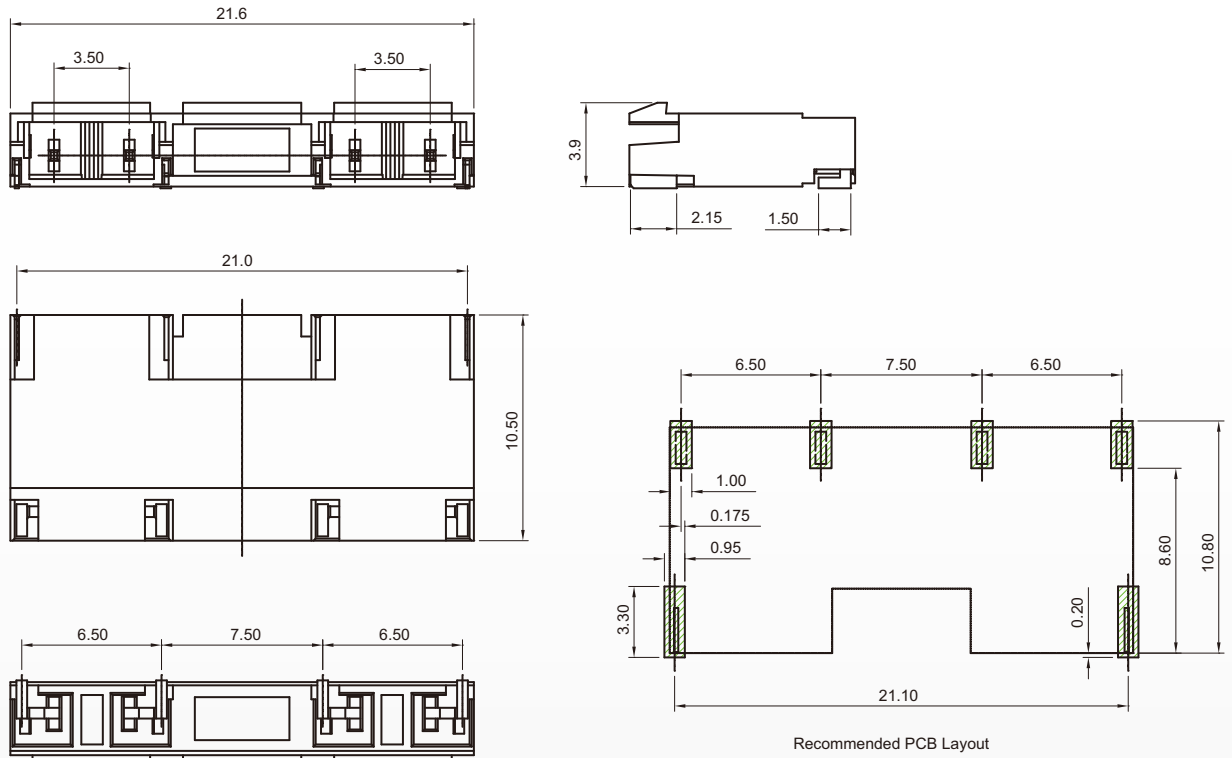

Wafer < DIP Type, With Lock > JS-20131D-04 (2 in 1)

