



Model:KM-38L180
Spur Gear Motor



Gear box length(mm)	Reduction Ratio
64	1/766

Outline:(unit:mm)

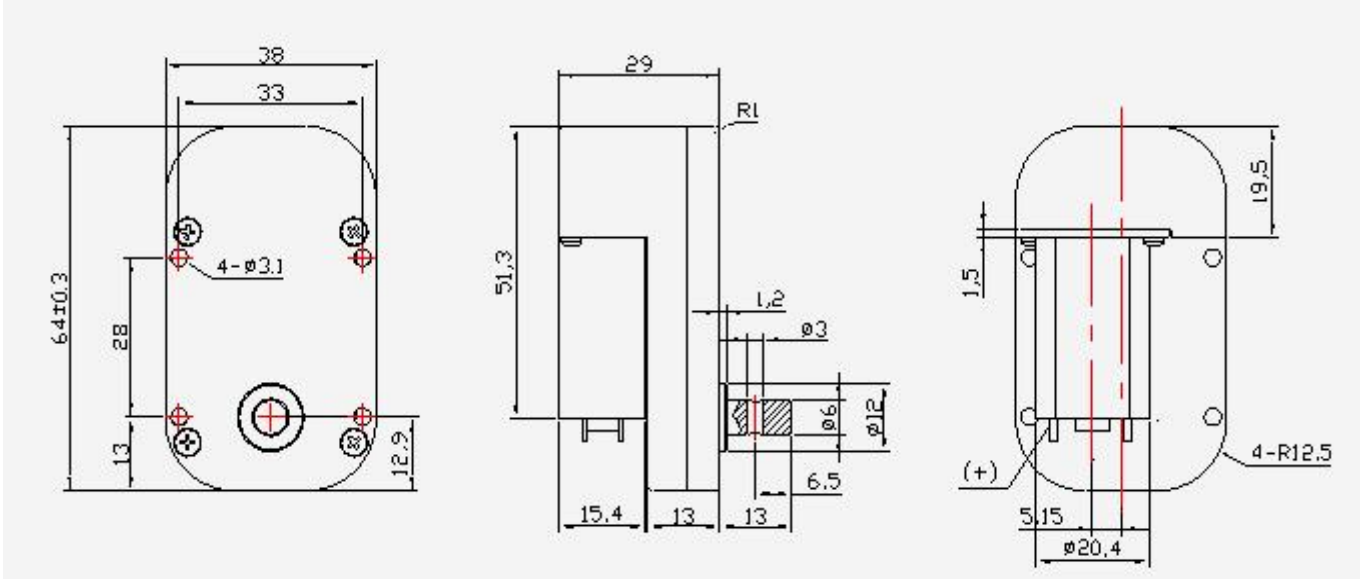

Gear Motor Technical Data:

Reduction Ratio	Voltage		No Load		On Load				
	Operating range	Nominal	Speed	Current	Speed	Current	Torque	Eff.	Output
	v	v	rpm	A	rpm	A	kg.cm	%	W
1/766	6.0-24.0	12.0	10	0.04	7.4	0.187	9.0	30.4	0.68

Unit Conversion: 1g.cm≈0.098mN.m≈0.014oz.in 1mm=0.039in 1g=0.035oz