

Rugged-Reliable Two-way Radio



Scrambler, 360° Rotatable Channel Knob, Channel Scan and CTCSS/DCS Scan

- 128 Memory Channels
- High Power Output 5W
- Compact Design with 3 keys and LCD Display
- Superb Clear and Enhanced Audio Quality
- Small Size, Light Weight and Easy Operating, for Amateur Use

S860

Amateur Two-way Radio

<http://www.sfecom.cn>

Main Features

- 128 Memory Channels
- Channel Display Mode Only
- CTCSS & DCS Manual Setting
- PC Programming
- Scan and Priority Scan
- Squelch Level Setting
- External Headset Jack
- TX/RX Resume Delay Time Setting
- H/M/L Power Selective
- Frequency Reverse Function
- Auto Battery Save
- VOX Function
- Keypad Lock
- Scrambler Function
- CTCSS & DCS Scan Function
- TOT(Time Out Timer)
- Look Back Time Setting
- Wide/Narrow Bandwidth Selective (25KHz/12.5KHz)
- 360° Rotatable Channel Knob
- Small Size and Light Weight

General

Frequency Range	UHF: 400-470MHz VHF: 136-174MHz
Channel Capacity	128CH
Channel Spacing	25/12.5KHz
Operating Voltage	DC: 7.2V
Battery Capacity	1300mAh(Li-Ion)
Battery Life (5-5-90 Duty Cycle)	About 11 Hours
Operating Temperature	-30℃~+60℃
Frequency Stability	±2.5ppm
Antenna Impedance	50Ω
Dimension(H*W*D) (Antenna Excluded)	100x52x32mm
Weight (Antenna & Battery Included)	215g

Transmitter

Output Power	VHF: 5W/1W UHF: 4W/1W
Frequency Error	≤ 5 X 10 ⁻⁶
Frequency Stability	+/-5ppm
Modulation Limiting	± 5.0KHz
Modulation Distortion	Less than 5%
Spurious Emission	≥ 65dB

Receiver

Reference Sensitivity	0.25μV
Adjacent Channel Selectivity	≥ 55dB
Spurious Response Rejection	≥ 55dB
Intermodulation	≥ 55dB
Audio Output	≥ 250mW
Audio Distortion	≤ 5%

Above specifications are tested according to TIA/EIA-603. Above specifications are subject to change without any notice due to technology enhancement.

Accessories

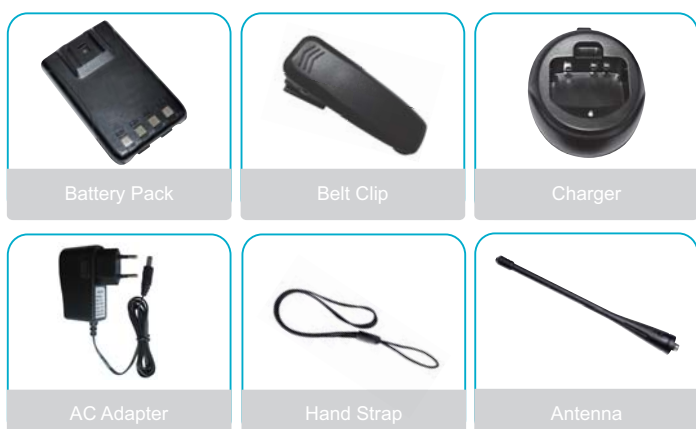

Your Local Dealer