

1. General Specifications

TW05001L-TW05001LT is a TFT-IPS-LCD module, TW05001L without touch panel, TW05001LT with capacitive touch panel. It is composed of a TFT-IPS-LCD panel, driver IC, FPC, a back light unit. The 5.0" display area contains 800 x 480 pixels and can display up to 16M colors. This product accords with RoHS

Item	Contents	Unit	Note
LCD Type	TFT	-	
Display color	16M		1
Viewing Direction	ALL	O'Clock	
Operating temperature	-20~+70	°C	
Storage temperature	-30~+80	°C	
Module size without touch panel	120.7*75.8*2.8	mm	2
Module size with touch panel	120.7*75.8*4.43	mm	2
Active Area(W×H)	108 x 64.8	mm	
Number of Dots	800×RGB×480	dots	
Power Supply Voltage	3.3	V	
Outline Dimensions	Refer to outline drawing	-	
Backlight	18-LEDs (white)	pcs	
Brightness(LCM)	500	CD/M ²	
Data Transfer	RGB	-	

environmental criterion

Note 1: Color tune is slightly changed by temperature and driving voltage.

Note 2: Without FPC and Solder, but with eight bumps。

2. Outline Drawing

基本规格:

DISPLAY TYPE:	5" TFT IPS LCD
NORMALLY BLACK	
TRANSMISSIVE	
RESOLUTION:	800 (RGB)*480
Driver IC:	ST7262
Viewing Angle (U/D/L/R) ALL:	500CD/M ² (TYP); (X=0, Y=0, Z=0, 31±0.03)
LCM BRIGHTNESS:	80% TYP
Chromaticity:	18pcs: 6串3并60mA(20mA/LLED)
Homogeneity:	RGB
Interface:	RGB
OPERATING TEMP:	-20°C ~ 70°C
STORAGE TEMP:	-30°C ~ 80°C
电压:	VCL: 3.3V
上偏光片	0.15 IPS 砂片
下偏光片	0.15 IPS 光面

产品规格

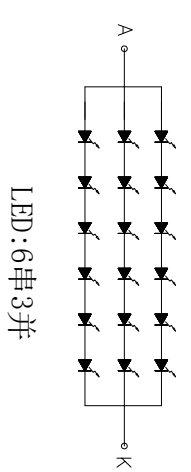

CTP接口定义:

PIN #	Assignment
1	shutdown
2	VCC
3	GND
4	INT
5	SDA
6	SCL

规格参数

1	产品结构类型	Glass+Glass
2	COVER LENS钢化类型	化学钢化
3	COVER LENS表面硬度	>6H
4	无油墨处透光率	大于等于86%
5	工作温度	-20°C ~ 70°C
6	储存温度	-30°C ~ 80°C

所有产品物料满足ROHS和无卤素要求

触控IC型号	GT911	通道数	20*12
供电电压	3.3V	工作电压	3.3V

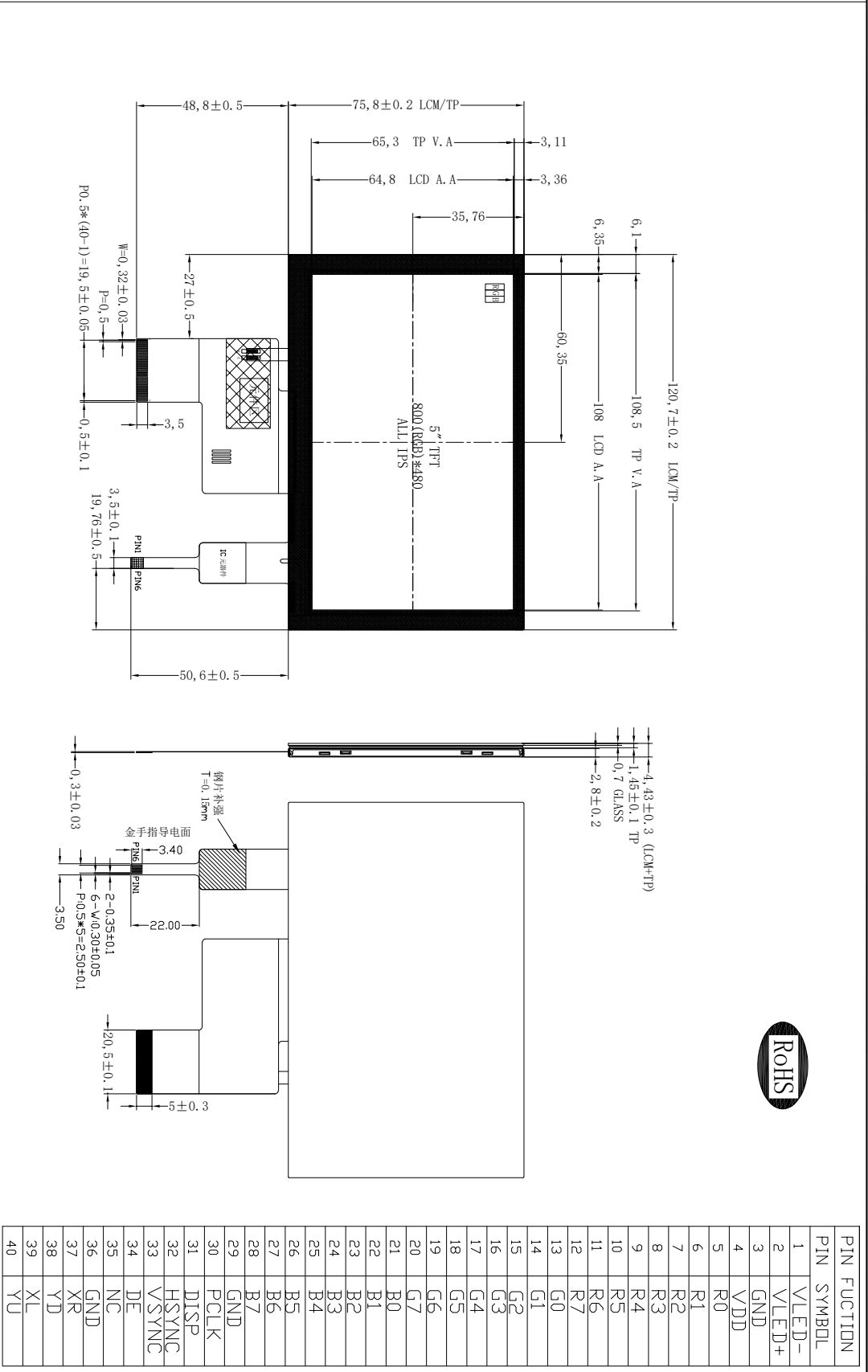

PIN	FUNCTION	PIN	FUNCTION
1	VLED-	21	B0
2	VLED+	22	B1
3	GND	23	B2
4	VDD	24	B3
5	R0	25	B4
6	R1	26	B5
7	R2	27	B6
8	R3	28	B7
9	R4	29	GND
10	R5	30	PCLK
11	R6	31	DISP
12	R7	32	HSYNC
13	G0	33	VSYNC
14	G1	34	DE
15	G2	35	NC
16	G3	36	GND
17	G4	37	XR
18	G5	38	YD
19	G6	39	XL
20	G7	40	YU

VER.	01	AMENDMENT	First issue	DESIGN	wang	DATE	2019. 08. 20
DRAWN				DRAWN			
ME. CHECKED				ME. CHECKED			
EE. CHECKED				EE. CHECKED			
APPROVED				APPROVED			
TITLE				MODULE SPEC.			
DRAWING NO.				TWO5001LT			
UNIT				mm			
SCALE				1:1			
SHEET				10F 1			
GOOD LIGHT DISPLAY							

3 Interface signals

Pin No.	Symbol	Function
1	LED_K	Backlight LED Ground
2	LED_A	Backlight LED Power
3	GND	GND
4	VDD	Power supply
5-12	R0-R7	Red data bus
13-20	G0-G7	Green data bus
21-28	B0-B7	Blue data bus
29	GND	GND
30	PCLK	Data clock
31	DISP	Standby mode select pin
32	HSYNC	Line SYNC signal
33	VSYNC	Frame SYNC signal
34	DE	Data Enable Input
35	NC	NC
36	GND	GND
37	XR	Touch Panel Control Pin
38	YD	
39	XL	
40	YU	

Pin No.	Symbol	Function
1	RST	Touch Reset pin 3.3V
2	VDD	Touch Digital Power 3.3V
3	GND	Ground
4	INT	Touch INT 3.3V
5	SDA	Touch SDA 3.3V
6	SCL	Touch SCL 3.3V