

● 产品示图

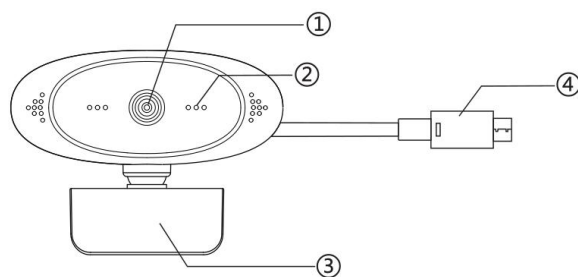

① 高清摄像头 ② 音频孔 ③ 摄像头支架 ④ USB2.0 端口

● 安装步骤

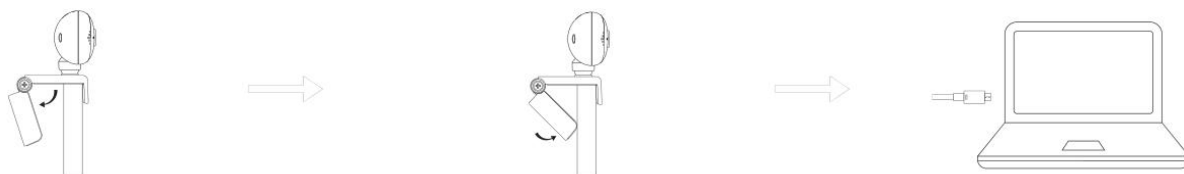

- 1 打开摄像头支架，镜头对着显示屏前方。
- 2 压下摄像头支架，前方扣住屏幕后端支架贴紧显示屏背方。
- 3 将 USB 数据线插入电脑 USB 接口即可。

● 产品参数

网络摄像头参数			
驱动类型	免装驱动即插即用	USB 线长	>=140cm
拍照格式	BMP	分辨率	1920*1080
传感器类型	CMOS	接口类型	USB2.0
闪烁控制	50Hz	麦克风	内置麦克风
调焦范围	20mm	产品尺寸	69*51.8*45.5mm
支持设备	支持主流电脑 Windows2000, XP, XP2, Vista, Win7, Win8, Win10, Mac OS, Linux 等操作系统		

● 产品配件

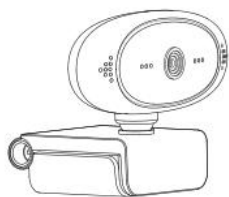

网络摄像头 *1

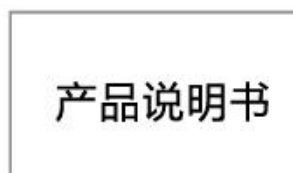

网络摄像头说明书*1

● Product structure diagram

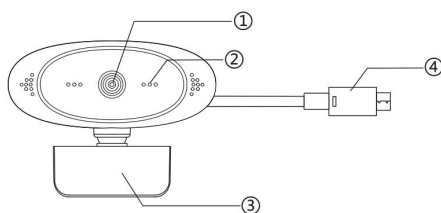

①HD camera ②MAC hole ③Trestle ④USB2.0

● Installation steps



1. Turn on the Camera Mount and point the camera toward the front of the display
2. Press down on the Camera Mount and snap the rear end of the screen mount to the back of the screen.
3. Plug the USB data cable into the USB interface of the computer.

● Detail parameter

Webcam parameters			
Driving type	Plug and play without driver	USB line length	>=140cm
Photo format	BMP	Resolving power	1920*1080
Sensor type	CMOS	Interface type	USB2.0
Scintillation control	50Hz	Microphone	Built-in microphone
focusing range	20mm	Product size	69*51.8*45.5mm
Support device	Support mainstream computer Windows 2000, XP, XP2, Vista, Win7, Win8, Win10, Mac OS, Linux operating system		

● Product accessories



Webcam*1

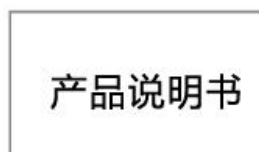

Webcam instructions*1