

SEM4810 Outline drawing (Unit: mm)

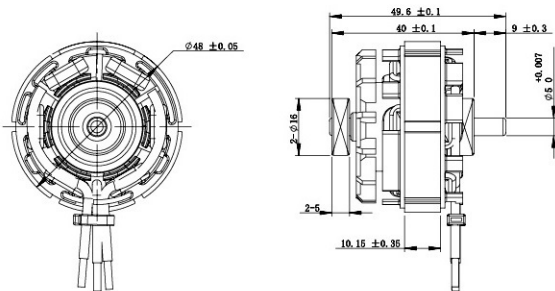

SEM4810 Performance curve

MODEL: SEM4810

DIRECTION OF ROTATION : CW AND CCW

VOLTAGE: 18.0 V

100.0 400.0 70.0 25000

η	P	I	N
80.0	320.0	56.0	20000
60.0	240.0	42.0	15000
40.0	160.0	28.0	10000
20.0	80.0	14.0	5000
EFFICIENCY-%	OUTPUT-W	CURRENT-A	SPEED-RPM

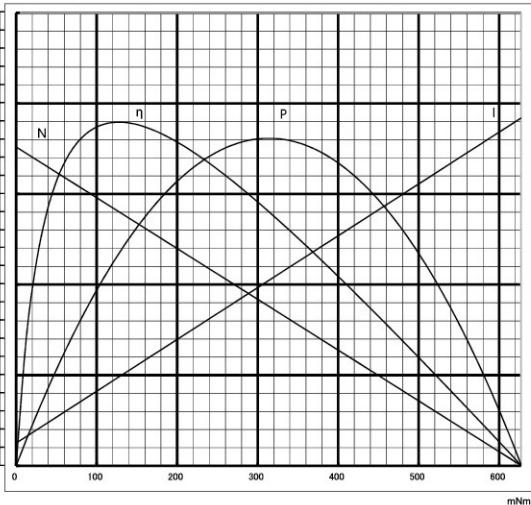

PERFORMANCE

AT NO LOAD:

SPEED = 17600 RPM
CURRENT = 3.500 A

AT STALL EXTRAPOLATION

TORQUE = 627.72 mN.m
CURRENT = 53.785 A

AT MAXIMUM EFFICIENCY

EFFICIENCY = 75.76 %
SPEED = 14023 RPM
TORQUE = 127.58 mN.m
CURRENT = 13.720 A
OUTPUT = 187.35 W

AT MAXIMUM OUTPUT

SPEED = 8800 RPM
TORQUE = 313.86 mN.m
CURRENT = 28.643 A
OUTPUT = 289.23 W
EFFICIENCY = 56.10 %

mNm