

编码规则 PART NUMBER DESIGNATION

KFH	30	60	P	T	S
Type 类型	Thread or Thru Hole Code 螺攻或孔攻代码	Length "L" Code 长度代码	Materials Code 材料代码	Finish Code 表面处理代码	Package Code 包装代码
M3x0.5	6.0mm	Steel P Phosphor Bronze	Tin N Nickel	S Bulk J Real	

All dimensions are in millimeters.

METRIC 公制尺寸	Thread Size x Pitch	Type	Thread or Thru Hole Code	Length "L" ± 0.25 (Length Code is in millimeters)						A (Shank) Max.	Min. Sheet Thickness	Hole Size In Sheet $+0.08$	Max. Hole Size In Attached Parts	H ± 0.25	S Max.	T ± 0.13	Min. Dist. Hole ϕ To Edge
				.250	.312	.375	.500	.625	.750								
M3x0.5	KFH	30	6	8	10	12	15	18	1.65	1.53	3	3.7	4.58	2.3	0.51	3.8	
M4x0.7	KFH	40	6	8	10	12	15	18	1.65	1.53	4.2	4.8	5.74	2.3	0.51	5.1	
M5x0.8	KFH	50	6	8	10	12	15	18	1.65	1.53	5	5.8	6.6	2.3	0.51	5.3	

All dimensions are in inches.

UNIFIED 英制尺寸	Thread Size	Type	Thread or Thru Hole Code	Length Code "L" ± 0.010 (Length code in 16nds of an inch)						A (Shank) Max.	Min. Sheet Thickness	Hole Size In Sheet $+0.003$	Max. Hole Size In Attached Parts	H ± 0.010	S Max.	T ± 0.005	Min. Dist. Hole ϕ To Edge
				.250	.312	.375	.500	.625	.750								
.112-40 (#4-40)	KFH	440	4	5	6	8	10	12	.065	.060	.120	.145	.180	.09	.020	.15	
.138-32 (#6-32)	KFH	632	4	5	6	8	10	12	.065	.060	.140	.170	.200	.09	.020	.19	
.164-32 (#8-32)	KFH	832	4	5	6	8	10	12	.065	.060	.166	.195	.225	.09	.020	.20	
.190-32 (#10-32)	KFH	032	4	5	6	8	10	12	.065	.060	.189	.220	.250	.09	.020	.20	

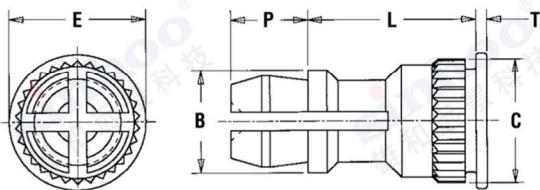

编码规则 PART NUMBER DESIGNATION

KSS	40	40	C	C	S
Type 类型	Top Board Mounting Hole Diameter Code 顶板安装孔直径代码	Length "L" Code 长度代码	Materials Code 材料代码	Finish Code 表面处理代码	Package Code 包装代码
M3x0.5	8.0mm	Steel S Aluminum S Stainless Steel	Tin N Nickel C Clean	S Bulk J Real	

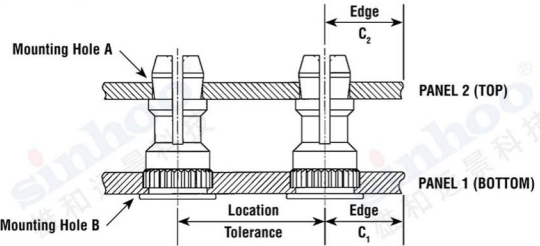

产品尺寸表 PRODUCT SIZE TABLE

All dimensions are in millimeters.

METRIC 公制尺寸	Type	Top Board Mounting Hole Diameter Code	Length Code "L" ± 0.13 (Length code in millimeters)										B ± 0.13	C ± 0.08	H ± 0.13	P ± 0.13	T ± 0.13
			8	10	12	14	16	18	20	22	25						
KSS		40	8	10	12	14	16	18	20	22	25	4.8	5.74	6.35	3.58	0.51	

All dimensions are in inches.

UNIFIED 英制尺寸	Type	Top Board Mounting Hole Diameter Code	Length Code "L" ± 0.005 (Length code in 32nds of an inch)										B $\pm .188$	C $\pm .226$	H $\pm .250$	P $\pm .141$	T $\pm .020$
			.250	.312	.375	.437	.500	.562	.625	.750	.875	1.00					
KSS		156	8	10	12	14	16	18	20	24	28	32	.188	.226	.250	.141	.020

安装尺寸表 INSTALLATION DIMENSION TABLE

All dimensions are in millimeters.

METRIC 公制尺寸	Type	Panel 1					Panel 2					
		Hardness Max.	Bottom Mounting Hole B $+0.08$	Panel Material	Thickness Min.	Edge Distance C, Min.	Location Tolerance	Hardness Max.	Top Mounting Hole A $+0.08$	Panel Material	Thickness Range	Edge Distance C, Min.
KSS		HRB 65/ HB 116	5.41	PC Board	1.27	5.59	± 0.13	No Limit	4	PC Board or Metal	1-1.8	2.54

All dimensions are in inches.

UNIFIED 英制尺寸	Type	Panel 1					Panel 2					
		Hardness Max.	Bottom Mounting Hole B $+0.003$	Panel Material	Thickness Min.	Edge Distance C, Min.	Location Tolerance	Hardness Max.	Top Mounting Hole A $+0.003$	Panel Material	Thickness Range	Edge Distance C, Min.
KSS		HRB 65/ HB 116	.213	PC Board	.050	.220	± 0.005	No Limit	.156	PC Board or Metal	.040-.070	.100