

ABIDE BY ROHS

■ Technical Specification :

- 1.Current Rating: 0.3A 30VDC
- 2.Contact Resistance: $\leq 100m\Omega$
- 3.Insulation Resistance: $\geq 100M\Omega$ DC500V
- 4.Withstand Voltage: AC1000V 1 minute
- 5.Operation Force: 90gf Max.
- 6.Releasing Force: $\geq 20gf$
- 7.Electrical Life: Min. 50,000 cycles
- 8.Mechanical Life: Min. 1,000,000 Cycles
- 9.Terminals: PVC-coated connecting wires AWG-26 moulded
- 10.Temperature range: $-40^{\circ}C$ to $+85^{\circ}C$
- 11.Degree of protection: IP67

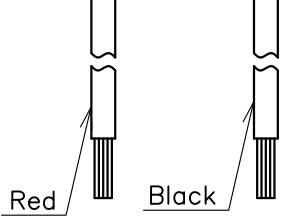
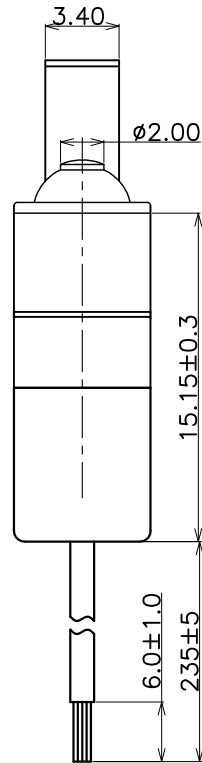
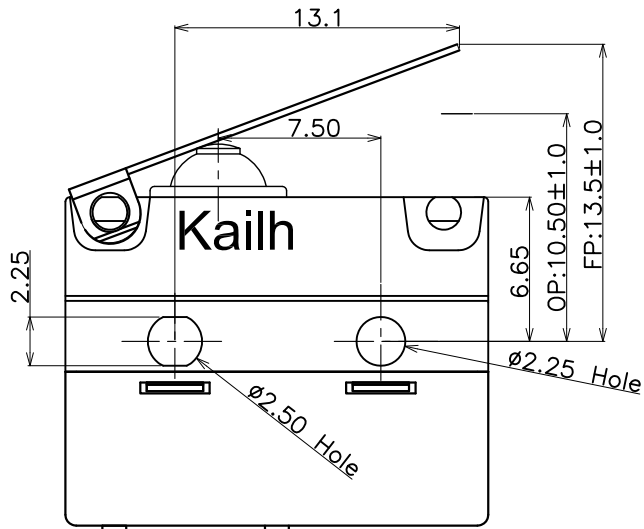
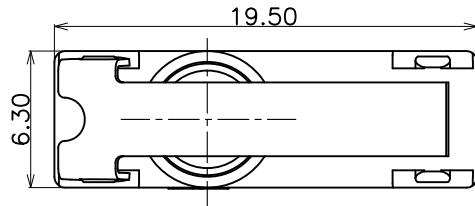

Electric Wire: UL1015 26AWG 7/0.16 0.13mm²
heat resistance 105°C

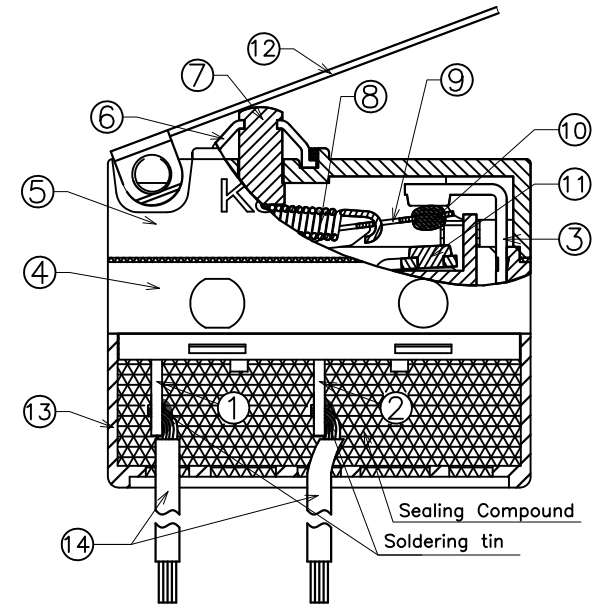
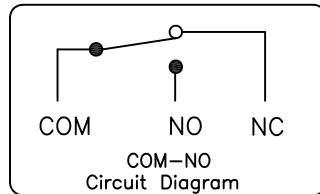

⑭	Electric Wire	—	2	PVC/Copper	Red/Black	—
⑬	Lower cover	—	1	PA66	Black	—
⑫	Lever	—	1	Stainless Steel	Natural	—
⑪	Stationary Contact	—	1	Silver Alloy/Copper	Au-Plated	—
⑩	Moving Contact	—	1	Silver Alloy/Copper	Au-Plated	—
⑨	Change Plate	—	1	Phosphor Bronze	Ag-Plated	—
⑧	Sprng	—	1	Stainless Steel	Natural	—
⑦	Button	—	1	PA66	Black	—
⑥	Gasket	—	1	Rubber	Orange	—
⑤	Upper Cover	—	1	PA66	Black	—
④	Base	—	1	PA66	Black	—
③	Nc Terminal	—	1	Brass	Natural	—
②	No Terminal	—	1	Brass	Ag-Plated	—
①	Com Terminal	—	1	Brass	Ag-Plated	—
ITEM	PART NAME	TER'NO.	QTY.	MATERIAL	FINISHING	REMARK

APPROVALS		DATE		东莞市凯华电子有限公司 <small>DONGGUAN CITY KAIHUA ELECTRONICS CO.,LTD</small>		
DRAWN	L.Zhang	2015.10.07		TITLE:	Sealed Micro Switch	
CHECKED				Customer No.		
APPROVALS				PART NO.	CMI190917L01	
TOLERANCES ARE		$\frac{30}{\leq L}$ ± 0.30 $\frac{10}{\leq L \leq 30}$ ± 0.20 $\frac{5}{\leq L \leq 10}$ ± 0.15 $L \leq 5$ ± 0.10	ANGLE	UNIT: mm	SCALE: 1:1	PROJ:
DRAWING NO.		KHA-MI1909-001EN		SHEET 1 OF 1		

ECN NO.	REV.	DATE.	DESCRIPTION.	CHANGE.	CHECK.	APPRO.
	A	2015.10.07	NEW		L.Zhang	



凱華電子
KAIHUA EEELETRONICS

Document Number:

KH-PS1805-44

产品规格书

Product Specification

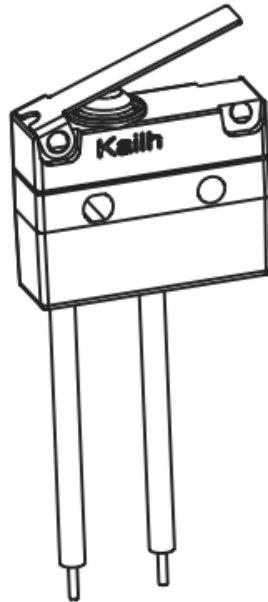

P/N:

CMI190917L01

Title :

MI1909 Sealed Micro Switch

Rev.	ECN	Release and Revision Description:	Prepared By /Date:	Checked By/Date:	Approved By/Date:
A	— —	New releasing 初版发行	张林/2015.08.10	张林/2015.08.10	陈军/2015.08.10
B	— —	更新图纸	张林/2018.05.30	易平/2018.05.30	王锋/2018.05.30



P/N: CMI190917L01	DOC. No.: KH-PS1805-44	Rev.: B	Page: 2/10
-----------------------------	----------------------------------	-------------------	----------------------

Content

目录

1. Scope/范围:	3
2. Product Application/产品应用:	3
3. Technology Parameters/技术参数	3
4. Ratings/额定性能要求	3
5. Profile Dimensions /外形尺寸	3
6. Electrical Performance/电气性能	4
7. Mechanical Performance/机械性能	5~6
8. Environmental Performance/环境性能	6~8
9. Loading Parameter Specification/荷重参数规格	9
10. Packaging/包装	9
11. Precaution/注意事项	9~10



P/N: CMI190917L01	DOC. No.: KH-PS1805-44	Rev.: B	Page: 3/10
-----------------------------	----------------------------------	-------------------	----------------------

1. Scope/范围:

This Product Specification covers the requirement of Mechanical Keyboard switch on product performance, test methods and quality assurance provisions.
本规格书内容涵盖机械键盘开关产品的要求，包括性能指标、测试方法及质量保证方面等。

2. Product Application/产品应用:

Mainly applied on the automobile, household appliances, electric tools, industrial control equipment, medical equipment, security equipment and other fields.
主要适用于汽车、家电、电动工具、工业控制设备、医疗设备、安防器材等。

3. Technology Parameters/技术参数

Ambient Humidity 工作湿度: 45~85% R.H.;

Operating Temperature Range 使用温度范围: -40℃~+85℃;

Storage Temperature Range 保存温度范围: -40℃~+85℃;

Suggested storage period 贮存期限: about 6 months 最多6个月

Require the tin part on the switch terminals should keep good after storage guarantee date
要求贮存期后开关端子部分上锡仍然良好。

Normal Condition:

Ambient temperature 环境温度: 20±2℃

Relative humidity 相对湿度: 65%±5% R.H.;

Air pressure 气压: 86~101KPa;

4. Ratings/额定性能要求

Rating 额定负荷: 0.3A 30VDC

Insulation Resistance 绝缘电阻: ≥100MΩ/DC 500V;

Withstand Voltage 耐电压: 1000 AC 1 Minute;

Electrical Life: 电气寿命: 50,000 cycles

Mechanical Life 机械寿命: 1,000,000 Cycles

5. Profile Dimensions /外形尺寸

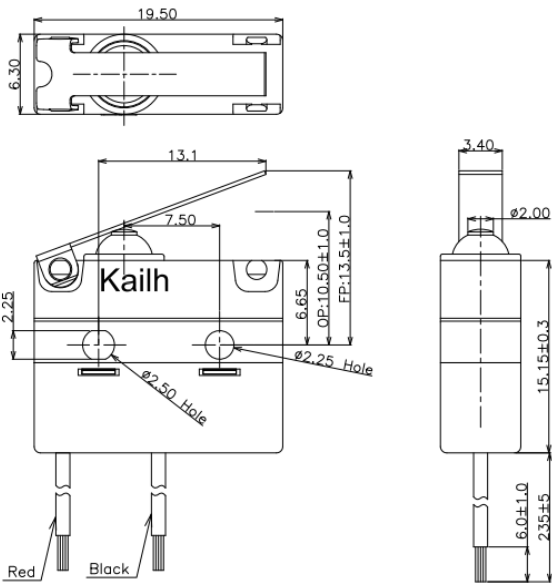

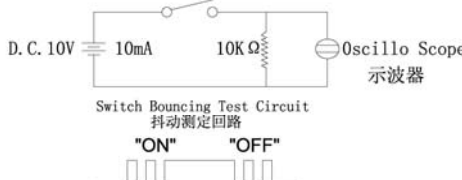

6. Electrical Performance/电气性能

Item 项目	Description 项目描述	Test Condition 测试条件	Requirement 规格要求
6.1	Contact Resistance 接触电阻	<p>Static load: (Operation force)x2, which is applied on the center of Switch stem.Be measured when the switch contact stabilization. 静态负载：动作力的 2 倍，施加在手柄中心。开关接触稳定时量测。</p> <p>Measurement tool: Contact resistance Meter. 测量工具：微电流接触电阻计(1KHz, 20mV,5~50mA)</p> <p>Measured at low current (100mA or less). 在低电流（≤100mA）条件下测试。</p>	<p>100mΩ Max 100mΩ 以下</p>
6.2	Insulation Resistance 绝缘电阻	<p>Apply a Voltage of DC 500 V for 1 minute, according to the below method. (1) Between non-connected terminals. (2) Between terminal and Body.</p> <p>输入 500V DC 电压 1 分钟，按如下接触方法测试： (1) 相互绝缘端子之间。 (2) 端子与外壳之间。</p>	<p>100MΩ Min 100 兆欧以上</p>
6.3	Dielectric withstanding voltage 耐电压	<p>Apply a Voltage of AC1000 V (50~60Hz) for 1 minute, according to the below method. (1) Between non-connected terminals. (2) Between terminal and Body.</p> <p>输入 1000V AC 电压 1 分钟，按如下接触方法测试： (1) 相互绝缘端子之间。 (2) 端子与外壳之间。</p>	<p>No evidence of breakdown 无瞬断、击穿等破坏。</p>
6.4	Bouncing 触点抖动	<p>Operation speed: 3~4 times/s 操作速度：每秒 3~4 次</p> <p>Oscillo scope 示波器 Switch Bouncing Test Circuit 抖动测定回路。</p> 	<p>Before Life cycle: On:5ms MAX,5 毫秒以下 Off: 5ms MAX,5 毫秒以下</p> <p>After Life cycle: On:10ms MAX,10 毫秒以下 Off: 10ms MAX,10 毫秒以下</p>

7. Mechanical Performance/机械性能

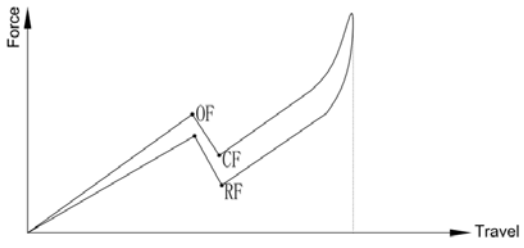
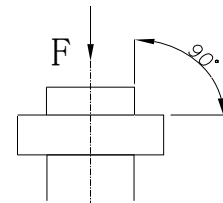
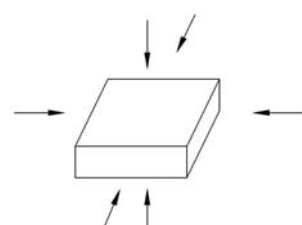
Item 项目	Description 项目描述	Test Condition 测试条件	Requirement 规格要求
7.1	Load Curve 荷重曲线	<p>Place the vertical direction of switch operation and gradually increase the load applied to the center of the stem until it stop. 开关的动作方向为垂直放置, 向手柄中心逐渐施加负荷直到停止.</p> 	See page 11 见第 11 页
7.2	Static Strength 静止强度	<p>A static load of 3kgf shall be applied in the direction of button operation for a period of 60 seconds. 在手柄动作方向施加 3kgf 的静负荷 60 秒, 然后测试参数.</p> 	No damage (Electrical) And mechanical) 电气和机械性能正常.
7.3	Pull Strength 拉拔强度	<p>Break by a pull force applied opposite to the direction of stem operation. 在推柄动作方向反向垂直施加拉力, 使其破坏的程度.</p>	3kgf Min
7.4	Shock 机械冲击	<p>Measured by according to the below condition: (1) Acceleration: 80g 加速度 (2) Cycles of test: 3 cycles each in 6 directions, for a total of 18 cycles. 试验次数: 每个方向 3 次, 6 个方向共 18 次.</p> 	Shall meet No.6, 7.1, 7.2. 满足 6, 7.1, 7.2 要求.



7.5	Life Test 寿命测试	<p>Electrical life</p> <p>1) D.C.30V 0.3A resistance load D.C 30V 0.3A 电阻负荷</p> <p>2) Operation speed : 60 times / minute 动作速度: 60 次/ 分</p> <p>3) Operation number: 50,000cycles 动作次数: 50, 000 次</p> <p>4) Actuation force: 150 gf 动作力: 150gf</p> <p>Mechanical life</p> <p>1) Without load 不带负荷</p> <p>2) Operation speed : 90 times / minute 动作速度: 90 次/ 分</p> <p>3) Operation number: 10,00,000cycles 动作次数: 1,000,000 次</p>	<p>Contact resistance: 5 Ω Max 接触电阻: 5 欧以下</p> <p>Bouncing: 10ms Max 触点抖动: 10 毫秒以下</p> <p>Operation force: Variation rate within ±30% 操作力的变化范围在初始值的±30%以内。</p>
-----	-------------------	--	---

8. Environmental Performance/环境性能

Item 项目	Description 项目描述	Test Condition 测试条件	Requirement 规格要求												
8.1	Cold test 耐寒性	<p>(1) Temperature : - 40±2℃ 温度: - 40±2℃</p> <p>(2) Duration of test: 96h 持续时间: 96 小时</p> <p>(3) Take off a drop water 去掉水珠</p> <p>(4) Standard conditions after test : 1h 试验后的放置条件: 1 小时</p>	<p>Contact resistance: 200m Ω Max Shall meet : No. 6.2 to 6.4 No. 7.1 to 7.2 接触电阻 200m Ω 以下 满足: No. 6.2 to 6.4 No. 7.1 to 7.2</p>												
8.2	Heat test 耐热性	<p>(1) Temperature : 85±2℃ 温度: 85±2℃</p> <p>(2) Duration of test: 96h 持续时间: 96 小时</p> <p>(3) Take off a drop water 去掉水珠</p> <p>(4) Standard conditions after test : 1h 试验后的放置条件: 1 小时</p>	<p>Contact resistance: 200m Ω Max Shall meet : No. 6.2 to 6.4 No. 7.1 to 7.2 接触电阻 200m Ω 以下 满足: No. 6.2 to 6.4 No. 7.1 to 7.2</p>												
8.3	Temperature cycle 温度循环	<p>(1) Test cycles: 5 cycles 试验周期: 5 个周期</p> <p>(2) Standard condition after test: 1h 试验后的放置条件: 1 小时</p> <table border="1" style="width: 100%; border-collapse: collapse;"> <thead> <tr> <th></th> <th>Temperature 温度</th> <th>Duration of test 持续时间</th> </tr> </thead> <tbody> <tr> <td rowspan="4" style="text-align: center;">1 cycle 一次循环</td> <td style="text-align: center;">20±5℃</td> <td style="text-align: center;">1h</td> </tr> <tr> <td style="text-align: center;">-40±5℃</td> <td style="text-align: center;">1h</td> </tr> <tr> <td style="text-align: center;">20±5℃</td> <td style="text-align: center;">1h</td> </tr> <tr> <td style="text-align: center;">85±5℃</td> <td style="text-align: center;">1h</td> </tr> </tbody> </table>		Temperature 温度	Duration of test 持续时间	1 cycle 一次循环	20±5℃	1h	-40±5℃	1h	20±5℃	1h	85±5℃	1h	<p>Contact resistance: 200m Ω Max Shall meet : No. 6.2 to 6.4 No. 7.1 to 7.2 接触电阻 200m Ω 以下 满足: No. 6.2 to 6.4 No. 7.1 to 7.2</p>
	Temperature 温度	Duration of test 持续时间													
1 cycle 一次循环	20±5℃	1h													
	-40±5℃	1h													
	20±5℃	1h													
	85±5℃	1h													

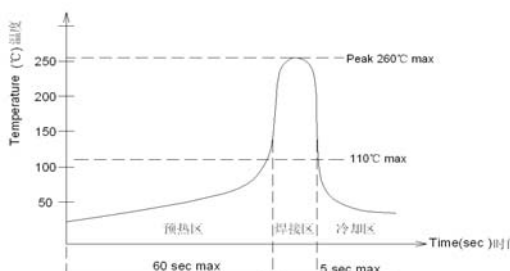

8.4	Soldering heat test 耐焊接热	<p>Soldering area: T/2 of PWB thickness. (PWB: T=1.6mm) 焊接面积: 印刷基板的 1/2 厚度处</p> <p>Soldering temperature: 260±5°C 焊接温度: 260±5°C</p> <p>Soldering time: 3±0.5s 焊接时间: 3±0.5 秒</p>	Appearance: No abnormality. 外观无异常
8.5	Solder ability 可焊性	<p>1. Hand soldering 手工焊接: Please practice according to below condition: (1) Soldering Temperature : 350±5°C 焊接温度: 350±5°C (2) Continual soldering time: 3±0.5s 连续焊接时间: 3±0.5 秒 (1) Capacity of soldering iron: ≤20w 电烙铁功率: 20 瓦以下</p> <p>2. Automatic PIP soldering 自动插板焊接: For the product of T/H according to below condition:</p> <p style="text-align: center;">波峰焊温度曲线图(单波峰)</p>  <p>The graph shows Temperature (°C) on the y-axis (0 to 250) and Time(sec) on the x-axis. It features a pre-heat zone (预热区) with a 60 sec max duration, a soldering zone (焊接区) with a 15 sec max duration, and a cooling zone (冷却区). The peak temperature is 260°C max, and the temperature at the end of the soldering zone is 110°C max.</p>	At least 95% of surface area of immersed portion shall be covered by solder. 浸焊面积大于 90%以上.
8.6	Humidity test 耐湿性	<p>(1) Temperature : 60±2°C 温度: 60±2°C</p> <p>(2) relative humidity: 90~95% R.H. 相对湿度:90~95% R.H.</p> <p>(3) Duration of test: 48h 持续时间: 48 小时</p> <p>(4) Take off a drop water 去掉水珠</p> <p>(5) Standard conditions after test: 1h 试验后的放置条件: 1 小时</p>	Contact resistance: 200mΩ Max Shall meet : No. 6.2 to 6.4 No. 7.1 to 7.2 接触电阻 200mΩ 以下 满足: No. 6.2 to 6.4 No. 7.1 to 7.2



8.7	Salt Spray 盐雾测试	<p>Apply the following environment to test: 根据下列条件进行测试:</p> <p>(1) Temperature : 35±5℃ 温度: 35±5℃;</p> <p>(2) Salt water density: 5±1% 盐水浓度: 5±1%;</p> <p>(3) Duration: 12hours 持续时间: 12 小时;</p> <p>(4) After test, the salt deposit shall be removed by running water. 实验后将盐沉积物用水冲掉</p>	<p>Appearance: No corrosion spot, no crack, no base plate naked. 外观: 无腐蚀点, 无裂纹, 无裸露基材.</p> <p>Contact Resistance: 200 mΩ Max 接触电阻: 200 毫欧以下</p>
8.8	Protection Against ingress of dust(IP6X) 防尘	<p>The switches are placed in a position of normal use inside the test chamber. The test is carried out according to the second enclosure of IEC60529/GB4208. The test shall be continued for a period of 8h.</p> <p>测试样品以正常使用位置在防尘箱中安装; 按 IEC60529 或 GB4208 防护标准测试条件进行试验; 试验应持续 8 小时;</p>	<p>After test: Operating is normal Between non connected terminals, terminal and surface of the crust, Dielectric withstand in voltage ≥100V</p> <p>动作正常; 相互绝缘端子之间及端子与外壳表面耐电压强度 ≥1000V</p>
8.9	Protection against ingress water(IPX7) 防水	<p>The switches are placed in a position of normal use inside the test table. The test is carried out according to the second enclosure of IEC60529/GB4208.</p> <p>测试样品以正常使用位置在防尘箱中安装; 按 IEC60529 或 GB4208 防护标准测试条件进行试验;</p>	<p>After test: Operating is normal. Water don't enter electric parts of the switch inside. Between terminals, terminal and surface of the crust, Dielectric withstand in voltage ≥1000V</p> <p>动作正常; 水不能进入开关内带电部份端子之间及端子与外壳表面耐电压强度 ≥1000V</p>



9. Loading Parameter (FP/OP/OF/OF/RF) Specification 荷重参数规格：

Parameter	Unit	Specification	Remark
FP(总行程)	mm	13.50±1.0	
OP(导通行程)	mm	10.50±1.0	
OF(动作力)	gf	90	Max
RF(回弹力)	gf	20	Min.

10. Packaging 包装

Packing Style 包装类型	Quantity 数量	Notes 说明
PE Bag 包装袋	100PCS	100PCS/Bag
Carton 纸箱	800PCS.	PE Bag: 8PCS

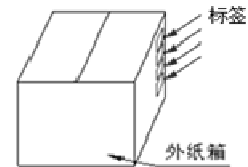
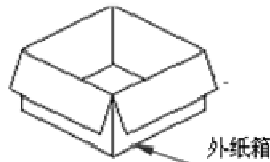

11.Precaution 注意事项

11.1 Immersion Soldering condition 浸焊条件

ITEM 项目	CONDITION 条件
Preheat temperature 预热温度	110°C Max (Ambient temperature of soldering surface of P.W.B) 110°C 以下(印刷基板焊锡面周围的温度)
Preheat time 预热时间	60s, Max 60 秒以内
Area of flux 助焊剂面积	1/2 Max of PWB Thickness 印刷基板厚度的 1/2 以内
Temperature of solder 焊锡温度	260±5°C 260±5°C
Time of immersion 浸焊时间	3s±0.5s 3s±0.5s
Number of soldering 焊接次数	2time Max (But should down heat of the first soldering) 2 次以内
Printed wiring board 印刷基板	Single side copper-clad laminates 单面铜箔

(1) After switches were soldered, please be careful not to clean switches with solvent
开关浸焊后,注意不要用溶剂清洗.

(2) Under the condition of using soldering iron, soldering temperature shall be 350°C±5°C with 3±0.5s.
在使用烙铁的情况下,焊锡温度应在350°C±5°C,焊接时间3±0.5秒.



P/N: CMI190917L01	DOC. No.: KH-PS1805-44	Rev.: B	Page: 10/10
----------------------	---------------------------	------------	----------------

11.2 Notes 注意点

- (1) Please be cautious not to give excessive static load or shock to switches.
注意不要施加超负荷的压力或晃动开关.
- (2) Please be careful not to stack up P. W. B. after switches were soldered.
开关焊接以后,印刷基板注意不要叠放.
- (3) Preservation under high temperature and high humidity or corrosive gas should be avoided
Especially. When you need to preserve for a long period, do not open the carton.
保管时尤其应注意避开高湿高温和有腐蚀性气体的环境.如需长时间保存,请不要打开包装箱.
- (4) Products meet the ROHS & REACH environmental management substances control standards
产品满足 ROHS & REACH 环境管理物质管制标准