

REV	DESCRIPTION	DRAWING/DATE	CHECK/DATE	APPROVED/DATE
A	NEW RELEASE			David 06/05/04

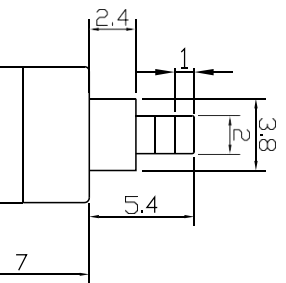

2.3
SWITCH TRAVEL 0.7±0.2

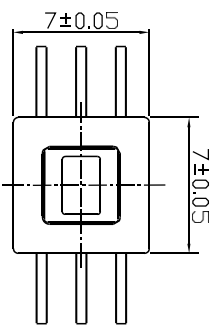
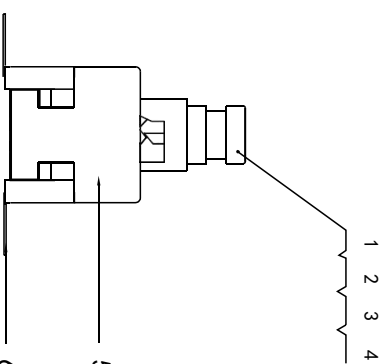
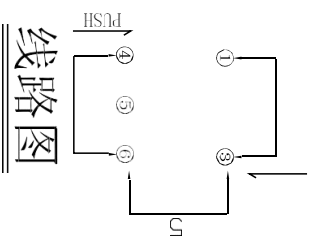
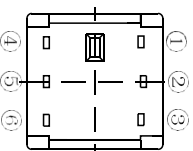
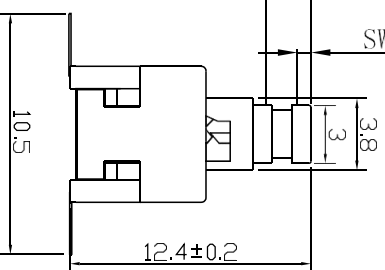

安装示意图

Main Specification:

1. Rating: DC 30V 0.1A
2. Withstand Voltage: AC 250V (50Hz) /min
3. Operation Force: 200±50gf
4. Life: 10000cycles

NO	散件名称	材 质	表面处理
1	盖子	9T	
2	按钮	9T	
3	簧片	磷铜	镀银
4	弹簧	不锈钢丝	
5	底座	9T	
6	引脚	H62	镀银

GENERAL TOLERANCE	ANGLE TOLERANCE
0.0--<2.0mm ±0.10mm	X° ±3.0°
2.0--<5.0mm ±0.15mm	X° ±2.0°
5.0--<10.0mm ±0.20mm	.XX° ±1.0°

MAJOR (QC CHECKED):
CONTROL POINT:
FA: to
CRITICAL (Cpk & Cp):
DI =

SCALE	UNIT
1 : 1	mm



东莞市福顺电子科技有限公司

DESIGN	DATE	TITLE
CHECK	06/05/04	7.0*7.0MM KEY-PRESS SWITCH
APPROVED	06/05/04	PB-22E07T

SERIES	KEY-PRESS SWITCH	SIZE
FS-PB-22E07-T-00-000		A3

REV A