

● Dimensions Drawing (外观图)

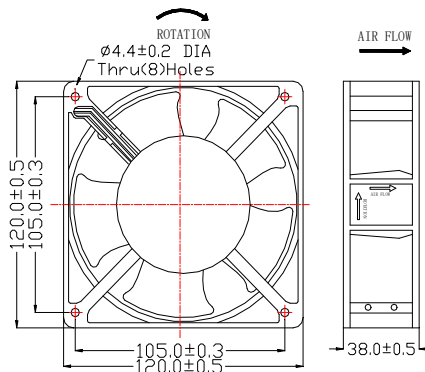

● General Specifications (一般规格)

○ Material:

Impeller: PBT UL 94V-0 Reinforced Plastic

Frame: Aluminium Alloy

○ Lead Wires: UL Type

○ Motor Protection: ImpeSance Protect

○ Insulation Resistance: 10MΩ Or Over With a DC500V Megger

○ Dielectric Withstand Voltage: AC1500V 3S

○ Allowable Ambient Temperature Range:

-10°C~+70°C (Operating)

-40°C~+70°C (Storage)

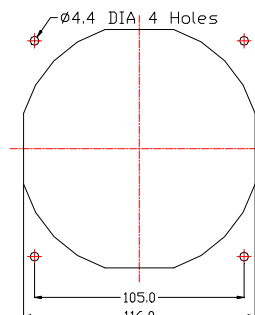

Inlet/Outlet

Unit:

● Specifications (规格)

(型号) Model	(轴承类型) Bearing Type	(电压) Rated Voltage	(频率) Fre-	(电流) Current	(功率) Power	(转数) Speed	(噪音) Noise Level	(风量) Air Flow		(风压) Static Pressure	(重量) Weight
		VDC	Hz	A	W	RPM	dBa	M ³ /hr	CFM	mmH ₂ O	g
SAH1238S	Sleeve	220-240	50/60	0.20	23/20	2600/3000	42/44	134/160	79/94	6.8/8.8	450
SAM1238S		220-240	50/60	0.16	15/14	2400/2700	40/43	127/141	75/83	5.2/6.5	
SAL1238S		220-240	50/60	0.10	10/9	2000/2400	36/40	104/127	61/75	2.8/4.2	
SAH1238S		100-125	50/60	0.30	23/20	2600/3000	42/44	134/160	79/74	6.8/8.8	
SAM1238S		100-125	50/60	0.25	15/14	2400/2700	40/43	127/141	75/83	5.2/6.5	
SAL1238S		100-125	50/60	0.20	10/9	2000/2400	36/40	104/127	61/75	2.8/4.2	
SAH1238B	Ball	220-240	50/60	0.20	23/20	2600/3000	42/44	134/160	79/94	6.8/8.8	
SAM1238B		220-240	50/60	0.16	15/14	2400/2700	40/43	127/141	75/83	5.2/6.5	
SAL1238B		220-240	50/60	0.10	10/9	2000/2400	36/40	104/127	61/75	2.8/4.2	
SAH1238B		100-125	50/60	0.30	23/20	2600/3000	42/44	134/160	79/74	6.8/8.8	
SAM1238B		100-125	50/60	0.25	15/14	2400/2700	40/43	127/141	75/83	5.2/6.5	
SAL1238B		100-125	50/60	0.20	10/9	2000/2400	36/40	104/127	61/75	2.8/4.2	

Notes: Specifications Subject To Change Without Notice

● Characteristic Curves (特性曲线)

