

DPG36-555

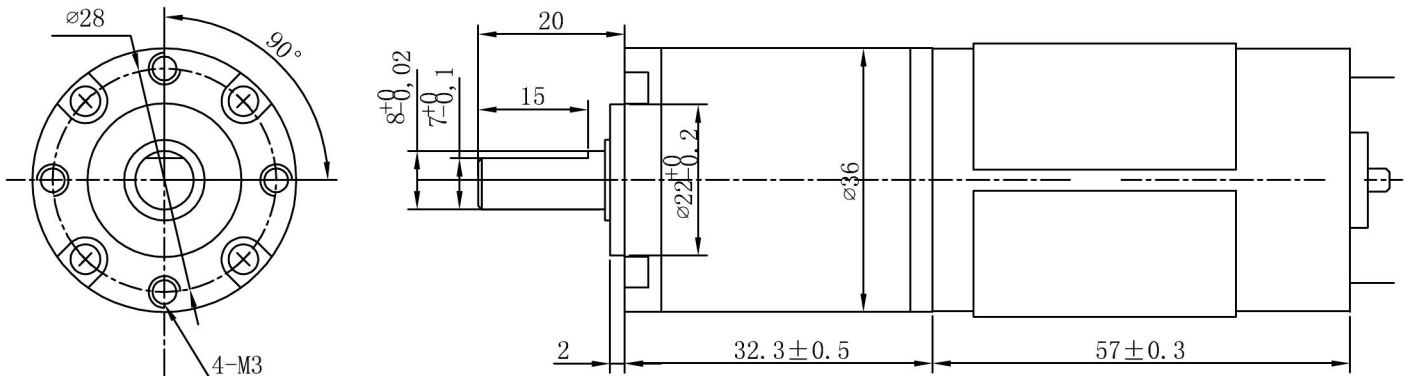

减速比 REDUCTION RATION	L (mm)	减速比 REDUCTION RATION	L (mm)
1/4~1/6	29	1/311~1/1608	53.8
1/13~1/40	37.4		
1/49~1/254	45.6		

外形尺寸/Dimensions



UNIT:MM

直流减速机参数/DC speed reducer parameters

电压 VOLTAGE	减速比 REDUCTION RATIO	1/4	1/6	1/13	1/25	1/40	1/56	1/74	1/112	1/158	1/254	1/311	1/370	1/441	1/625	1/707	1/792		
12	额定扭力 (kg-cm) RATED TORQUE	0.5	0.8	1.5	2.9	4.7	5.7	7.5	11	16	26	26.5	31.5	37	50	50	50		
	额定转速 (rpm) RATED SPEED	950	633	292	152	95	68	51	34	24	15	12	10	9	6	5	5		
	瞬间容许扭力 (kg-cm) MAX MOMENTARY TOLERANCE	3	5	10	19	30	36	48	60	60	60	75	75	75	75	75	75		
	空载转速 (rpm) NO LOAD CURRENT	1125	750	346	180	113	80	61	40	28	18	14	12	10	7	6	6		
24	额定扭力 (kg-cm) RATED TORQUE	0.8	1.2	2.2	4.3	7	8	11	16	23	38	38	46	50	50	50	50		
	额定转速 (rpm) RATED SPEED	938	625	288	150	94	67	51	33	24	15	12	10	9	6	5	5		
	瞬间容许扭力 (kg-cm) MAX MOMENTARY TOLERANCE	4	6	12	24	37	47	62	60	60	60	75	75	75	75	75	75		
	空载转速 (rpm) NO LOAD CURRENT	1141	761	351	183	114	82	62	41	29	18	15	12	10	7	6	6		

电机参数/Motor data

型号 MODEL	额定电压 RATED VOLT V	空载 NO LOAD		最大效率 AT MAXIMUM EFFICIENCY					堵转	
		转速 SPEED r/min	电流 CURRENT A	转速 SPEED r/min	电流 CURRENT A	扭矩 TORQUE g. cm	输出功率 OUT PUT W	效率 EFF %	扭矩 TORQUE g. cm	电流 CURRENT A
DRC-555PH-2670	12	4500	0.20	3800	0.83	170.5	6.69	67.2	1100	4.26
DRC-555PH-19115	24	4565	0.1	3750	0.62	250	9.63	65	1400	3.0