

DGB37-555

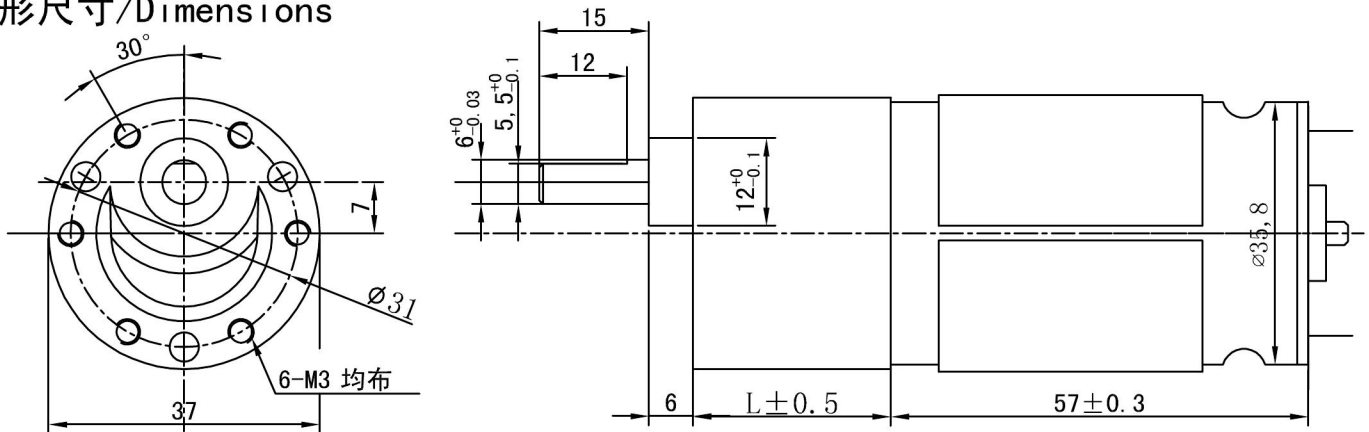

减速比 REDUCTION RATION	L (mm)	减速比 REDUCTION RATION	L (mm)
1/5~1/10	23	1/120~1/300	30.5
1/15~1/30	25.5		
1/35~1/100	28		

外形尺寸/Dimensions



UNIT:MM

直流减速机参数/DC speed reducer parameters

电压 VOLTAGE	减速比 REDUCTION RATIO	1/5	1/10	1/15	1/18	1/25	1/30	1/35	1/50	1/60	1/76	1/90	1/100	1/120	1/150	1/200	1/255	1/300
		12	额定扭力 (kg-cm) RATED TORQUE	0.6	1.0	1.7	2.0	2.0	2.0	3.0	3.0	3.0	3.0	3.0	3.0	6.0	6.0	6.0
	额定转数 (rpm) RATED SPEED	760	380	253	211	152	127	110	77	65	52	44	40	35	28	22	18	16
	瞬间容许扭力 (kg-cm) MAX MOMENTARY TOLERANCE TORQUE	3.0	3.0	6.0	6.0	6.0	6.0	9.0	9.0	9.0	9.0	9.0	9.0	18.0	18.0	18.0	18.0	18.0
	空载转数 (rpm) NO LOAD CURRENT	900	450	300	250	180	150	129	90	75	59	50	45	38	30	23	18	15
24	额定扭力 (kg-cm) RATED TORQUE	1.0	1.0	2.0	2.0	2.0	2.0	3.0	3.0	3.0	3.0	3.0	3.0	6.0	6.0	6.0	6.0	6.0
	额定转数 (rpm) RATED SPEED	750	375	252	210	152	127	109	77	65	51	44	40	34	28	22	18	16
	瞬间容许扭力 (kg-cm) MAX MOMENTARY TOLERANCE TORQUE	3.0	3.0	6.0	6.0	6.0	6.0	9.0	9.0	9.0	9.0	9.0	9.0	18.0	18.0	18.0	18.0	18.0
	空载转数 (rpm) NO LOAD CURRENT	913	457	304	254	183	152	130	91	76	60	51	46	38	30	23	18	15

电机参数/Motor data

型号 MODEL	额定电压 RATED VOLT V	空载 NO LOAD		最大效率 AT MAXIMUM EFFICIENCY					堵转	
		转速 SPEED r/min	电流 CURRENT A	转速 SPEED r/min	电流 CURRENT A	扭矩 TORQUE g. cm	输出功率 OUT PUT W	效率 EFF %	扭矩 TORQUE g. cm	电流 CURRENT A
		DRC-555PH-2670	12	4500	0.20	3800	0.83	170.5	6.69	67.2
DRC-555PH-19115FV	24	4565	0.10	3750	0.62	250	9.63	65	1400	3.0