

<p>B0800 Keylock switch 125V 0.2A</p>				<p>Zinc alloy die cast housing</p> <table border="1"> <thead> <tr> <th>Item#</th> <th>Terminals</th> <th>Key pulls</th> <th>Turn</th> <th>off</th> <th>on</th> </tr> </thead> <tbody> <tr> <td>B0800</td> <td>2</td> <td>2</td> <td>90°</td> <td>off</td> <td>on</td> </tr> </tbody> </table>	Item#	Terminals	Key pulls	Turn	off	on	B0800	2	2	90°	off	on																								
Item#	Terminals	Key pulls	Turn	off	on																																			
B0800	2	2	90°	off	on																																			
<p>B0811 - B0812 Keylock switch 125V 1A (250V 0.5A)</p>				<p>Zinc alloy die cast housing</p> <table border="1"> <thead> <tr> <th>Item#</th> <th>Terminals</th> <th>Key pulls</th> <th>Turn</th> <th>off</th> <th>on</th> </tr> </thead> <tbody> <tr> <td>B0811</td> <td>4</td> <td>3</td> <td>45° -0° -90°</td> <td>off</td> <td>on</td> </tr> <tr> <td>B0812</td> <td>2</td> <td>2</td> <td>90°</td> <td>off</td> <td>on</td> </tr> </tbody> </table>	Item#	Terminals	Key pulls	Turn	off	on	B0811	4	3	45° -0° -90°	off	on	B0812	2	2	90°	off	on																		
Item#	Terminals	Key pulls	Turn	off	on																																			
B0811	4	3	45° -0° -90°	off	on																																			
B0812	2	2	90°	off	on																																			
<p>B0815 Keylock switch 125V 0.2A</p>				<p>Zinc alloy die cast housing</p> <table border="1"> <thead> <tr> <th>Item#</th> <th>Terminals</th> <th>Key pulls</th> <th>Turn</th> <th>off</th> <th>on</th> </tr> </thead> <tbody> <tr> <td>B0815</td> <td>2</td> <td>2</td> <td>90°</td> <td>off</td> <td>on</td> </tr> </tbody> </table>	Item#	Terminals	Key pulls	Turn	off	on	B0815	2	2	90°	off	on																								
Item#	Terminals	Key pulls	Turn	off	on																																			
B0815	2	2	90°	off	on																																			
<p>B0820 - B0821 Keylock switch 125V 1A (250V 0.5A)</p>				<p>Zinc alloy die cast housing</p> <table border="1"> <thead> <tr> <th>Item#</th> <th>Terminals</th> <th>Key pulls</th> <th>Turn</th> <th>off</th> <th>on</th> </tr> </thead> <tbody> <tr> <td>B0820</td> <td>2</td> <td>1</td> <td>90°</td> <td>off</td> <td>on</td> </tr> <tr> <td>B0821</td> <td>2</td> <td>2</td> <td>90°</td> <td>off</td> <td>on</td> </tr> </tbody> </table>	Item#	Terminals	Key pulls	Turn	off	on	B0820	2	1	90°	off	on	B0821	2	2	90°	off	on																		
Item#	Terminals	Key pulls	Turn	off	on																																			
B0820	2	1	90°	off	on																																			
B0821	2	2	90°	off	on																																			
<p>B0825 - B0829 Keylock switch 125V 1A (250V 0.5A)</p>				<p>Zinc alloy die cast housing</p> <table border="1"> <thead> <tr> <th>Item#</th> <th>Terminals</th> <th>Key pulls</th> <th>Turn</th> <th>off</th> <th>on</th> </tr> </thead> <tbody> <tr> <td>B0825</td> <td>2</td> <td>1</td> <td>90°</td> <td>off</td> <td>on</td> </tr> <tr> <td>B0826</td> <td>2</td> <td>2</td> <td>90°</td> <td>off</td> <td>on</td> </tr> <tr> <td>B0827</td> <td>4</td> <td>1</td> <td>90°</td> <td>on</td> <td>on</td> </tr> <tr> <td>B0828</td> <td>4</td> <td>2</td> <td>90°</td> <td>on</td> <td>on</td> </tr> <tr> <td>B0829</td> <td>2</td> <td>1</td> <td>90°</td> <td>off</td> <td>(on)</td> </tr> </tbody> </table>	Item#	Terminals	Key pulls	Turn	off	on	B0825	2	1	90°	off	on	B0826	2	2	90°	off	on	B0827	4	1	90°	on	on	B0828	4	2	90°	on	on	B0829	2	1	90°	off	(on)
Item#	Terminals	Key pulls	Turn	off	on																																			
B0825	2	1	90°	off	on																																			
B0826	2	2	90°	off	on																																			
B0827	4	1	90°	on	on																																			
B0828	4	2	90°	on	on																																			
B0829	2	1	90°	off	(on)																																			
<p>B0830 Keylock switch 125V 1A (250V 0.5A)</p>				<p>Zinc alloy die cast housing</p> <table border="1"> <thead> <tr> <th>Item#</th> <th>Terminals</th> <th>Key pulls</th> <th>Turn</th> <th>off</th> <th>on</th> </tr> </thead> <tbody> <tr> <td>B0830</td> <td>2</td> <td>2</td> <td>90°</td> <td>off</td> <td>on</td> </tr> </tbody> </table>	Item#	Terminals	Key pulls	Turn	off	on	B0830	2	2	90°	off	on																								
Item#	Terminals	Key pulls	Turn	off	on																																			
B0830	2	2	90°	off	on																																			
<p>B0840 - B0841 Keylock switch 125V 1A (250V 0.5A)</p>				<p>Zinc alloy die cast housing</p> <table border="1"> <thead> <tr> <th>Item#</th> <th>Terminals</th> <th>Key pulls</th> <th>Turn</th> <th>off</th> <th>on</th> </tr> </thead> <tbody> <tr> <td>B0840</td> <td>2</td> <td>1</td> <td>90°</td> <td>off</td> <td>on</td> </tr> <tr> <td>B0841</td> <td>2</td> <td>2</td> <td>90°</td> <td>off</td> <td>on</td> </tr> </tbody> </table>	Item#	Terminals	Key pulls	Turn	off	on	B0840	2	1	90°	off	on	B0841	2	2	90°	off	on																		
Item#	Terminals	Key pulls	Turn	off	on																																			
B0840	2	1	90°	off	on																																			
B0841	2	2	90°	off	on																																			

B0860 - B0870
Keylock switch
125V 4A (250V 2A)

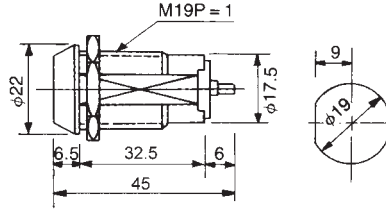
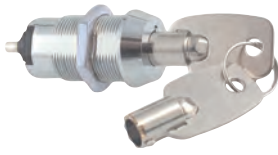

Zinc alloy die cast housing

Item#	Terminals	Key pulls	Turn	
B0860	2	1	90°	off on
B0861	2	2	90°	off on
B0862	2	1	90°	off (on)
B0870	4	3	45°-0°-45°	on off on

(): Momentary. Many combinations available

B0884 - B0888
Keylock switch
125V 4A (250V 2A)

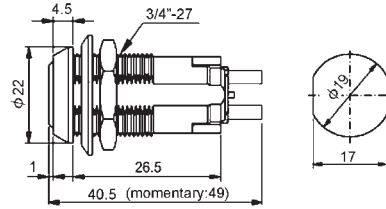

Zinc alloy die cast housing

Item#	Terminals	Key pulls	Turn	
B0884	2	1	90°	off on
B0885	2	2	90°	off on
B0888	2	1	90°	off (on)

(): Momentary. Many combinations available

B0930 - B0941
Keylock switch
125V 4A (250V 2A)

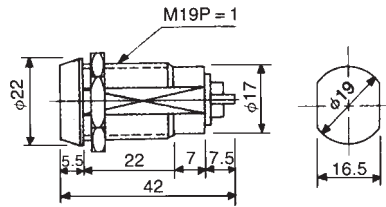

Zinc alloy die cast housing

Item#	Terminals	Key pulls	Turn	
B0930	2	1	90°	off on
B0931	2	2	90°	off on
B0940	3	1	90°	on on
B0941	3	2	90°	on on

• Many combinations available

B09451 - B09454
Keylock switch
125V 4A (250V 2A)

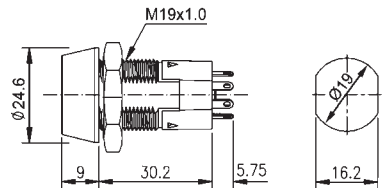

Zinc alloy die cast housing

Item#	Terminals	Key pulls	Turn	
B09451	3	1	90°	on on
B09453	4	1	45°	on on on
B09454	4	1	45°-0°-45°	on on on

• Many combinations available

B09461 - B09466
Keylock switch
125V 4A (250V 2A)

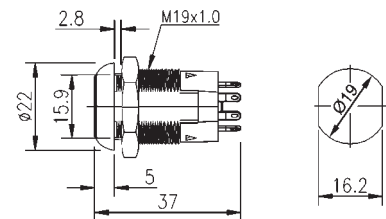

Zinc alloy die cast housing

Item#	Terminals	Key pulls	Turn	
B09461	3	1	90°	on on
B09463	4	1	45°	on on on
B09464	4	1	45°-0°-45°	on on on
B09466	6	2	90°	on on

• Many combinations available

B0950 - B0953
Keylock switch
125V 4A (250V 2A)

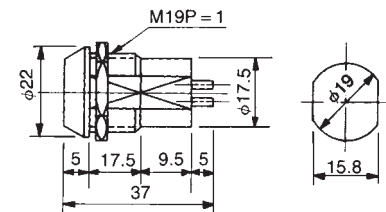

Zinc alloy die cast housing

Item#	Terminals	Key pulls	Turn	
B0950	4	1	90°	off on
B0951	4	2	90°	off on
B0952	4	1	90°	on on
B0953	4	2	90°	on on

• Many combinations available

B0960 - B0961
Keylock switch
125V 1A (250V 0.5A)

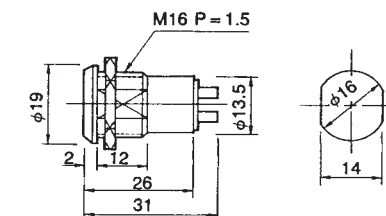

Zinc alloy die cast housing

Item#	Terminals	Key pulls	Turn	
B0960	2	2	60°	off on
B0961	3	3	60°	off on on

• Many combinations available

B0970 - B0971
Keylock switch
125V 1A (250V 0.5A)

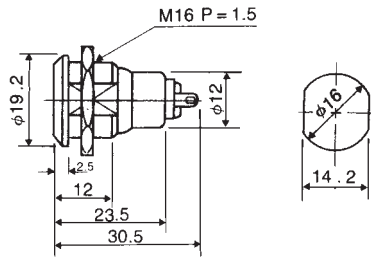

Zinc alloy die cast housing

Item#	Terminals	Key pulls	Turn	
B0970	2	1	90°	off on
B0971	2	2	90°	off on

• Many Combinations available

B0975
Keylock switch
125V 1A (250V 0.5A)

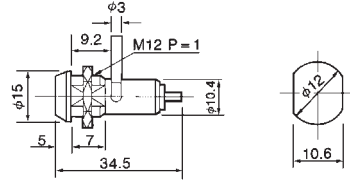
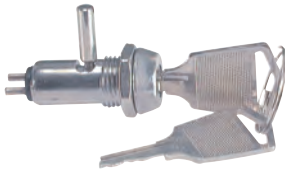

Zinc alloy die cast housing

Item#	Terminals	Key pulls	Turn	
B0975	2	2	90°	off on

• Many Combinations available

B0980 - B0981
Cam lock

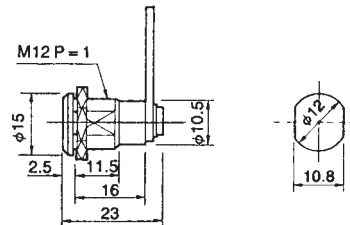

Zinc alloy die cast housing

Item#	Terminals	Key pulls	Turn	
B0980		1	90°	
B0981		2	90°	

• Many Combinations available

B0982 - B0983
Cam lock

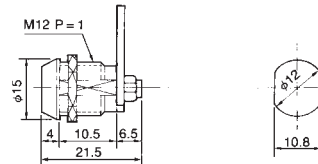

Zinc alloy die cast housing

Item#	Terminals	Key pulls	Turn	
B0982		1	90°	
B0983		2	90°	

• Many Combinations available

B09960
Fingerprint identification
cabinet lock

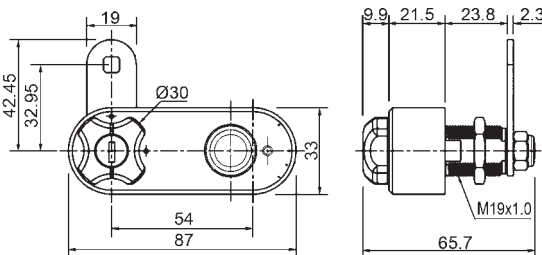

20 Groups of Fingerprints



USB Rechargeable



High performance chip



Automatic storage

Zinc alloy housing with bright chrome plating

Features:

- LED light and buzzer operation guidance
- Low battery alert supported
- External USB port for recharge & emergency power

Specifications:

- Sensor resolution: 176x176
- Fingerprint sensor: Capacitive type sensor
- Fingerprint capacity: 20 sets
- Lithium-ion polymer battery: 3.7V/500mAh
- Battery life: 1 year or 2500 lock/unlock actions after full charging
- 2 keys each lock

Add fingerprint:

1. At unlock position and press the fingerprint lock panel, when blue light is on then hold until the blue light is always on and with long beep 1 time, then remove.
2. The purple light flashes, start fingerprint entry.
3. Press the fingerprint lock panel until the blue light is on and beep 1 time, then remove.
4. Repeat step 3 for 5 times to collect the same finger, and the fingerprint is collected successfully.
5. The green light is on, the entry is successful; the red light is on, the entry fails.

Delete fingerprint:

1. At unlock position and press the fingerprint lock panel, when blue light is on then hold until the white light is always on and with beep 3 times (green light flashes and purple light is on during the period).
2. Continue hold until green/red/blue light is switching around 5 seconds.
3. After the white light is always on and with long beep 1 time, then green light flashes 3 times, the fingerprint is deleted successfully.