



Category

SWITCH

- ANTI-VANDAL SW
- ROCKER SW
- PUSH SW
- TOGGLE SW
- MICRO/DETECTOR SW
- SLIDE SW
- ROTARY SW
- DIP SW
- TACT SW
- KEYLOCK SW
- CAPACITANCE SW
- SAFETY & CONTROL SW
- VEHICLE SW
- THERMOSTAT SW
- BATTERY SW
- TRIGGER SW

SOCKET

INDICATOR

SENSOR

ELECTRO-MODULE

BREAKER

FUSE HOLDER

FUSE

ENCODER

POTENTIOMETER

CONNECTOR

WIRE HARNESS

NEW PRODUCT

Products Search



OUR PRODUCT

Home ▶ Our Product ▶ LA139S (Miniature type) ▶ LA139S (Miniature type)

SWITCH / SAFETY & CONTROL SW

**LA139S (Miniature type)
M16 Panel Mounted Sealed Emergency
Stop Switches with IP65 Protection
Level**

Panel cutout Ø16mm
SPST or SPDT circuit
Sealed to IP65
Various actuator sizes and styles



ZOOM IN

PDF Download

Get Information

Print this page

Feature

- Rating: 3A 125/250VAC
- Contact resistance: 50mΩ initial (Max.)
- Insulation resistance: 100MΩ (Min.)
- Electrical life: 50, 000 cycles
- Mechanical life: 1,000, 000 cycles
- Operation Temperature: -20°C~ 55°C
- Installed diameter Ø16 mm
- Contact type: 1NC, 1NO+1NC
- Protection level: IP65
- Actuator material: PC
- Applications: industrial control panel, machine and equipment, automotive, power distribution system

Specification

How to order

LA139S – 11 ZS – A L / P

CONTACT	ACTUATOR TYPE	FUNCTION	TERMINAL	KNOB SHAPE
01 1NC SPST	ZS Emergency Stop	A Push Lock	S Short Type L Long Type	A
11 1NO + 1NC SPDT				K
				P

Item



LA139S-11ZS-AL/P

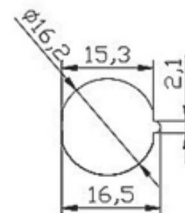
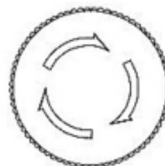
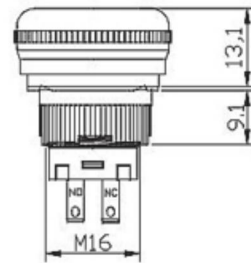
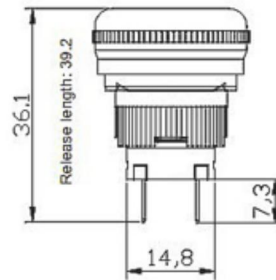

LA139S-01ZS-AL/K

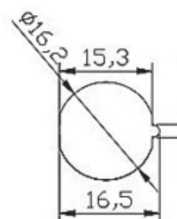
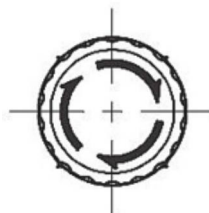
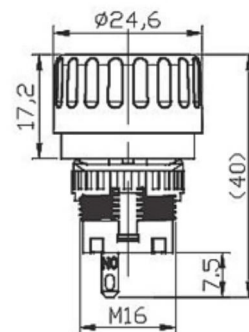
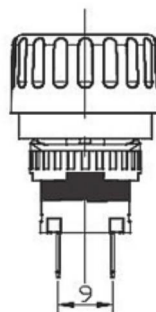

LA139S-01ZS-AS/A

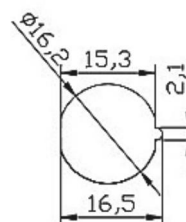
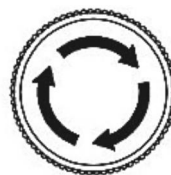
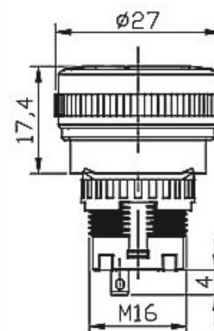
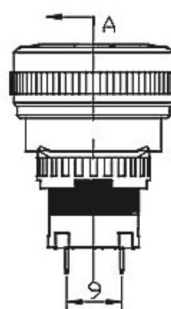

◀ BACK



5F., No.10, Lane 218, Sec. 2, Zhongxing Rd., Xindian Dist., New Taipei City 23146, R. O. C.

Tel: +886-2-29161263 Fax: +886-2-29117574 canal@c-components.com.tw

©2009 Canal Components Inc. All Rights Reserved